

# SWITCH



## A GREAT PLACE TO START

Simple and sophisticated, the Sunliner Switch is well equipped and modern making your motorhome lifestyle easy.

### FEATURES

- A Winning Combination-** Superior design and performance expected of a Sunliner RV with exceptional value for money. The comprehensive list of standard inclusions ensures that you don't have to compromise to own a new Sunliner.
- An Easy Choice-** The Switch range combines the most popular elements of our RVs and packages them in effortless, simple and modern motorhomes.
- Sleep Easy-** With 8 layouts including sleeping options of island, single and electric drop beds, including bunks, there is a Switch to suit all your snoozing needs.

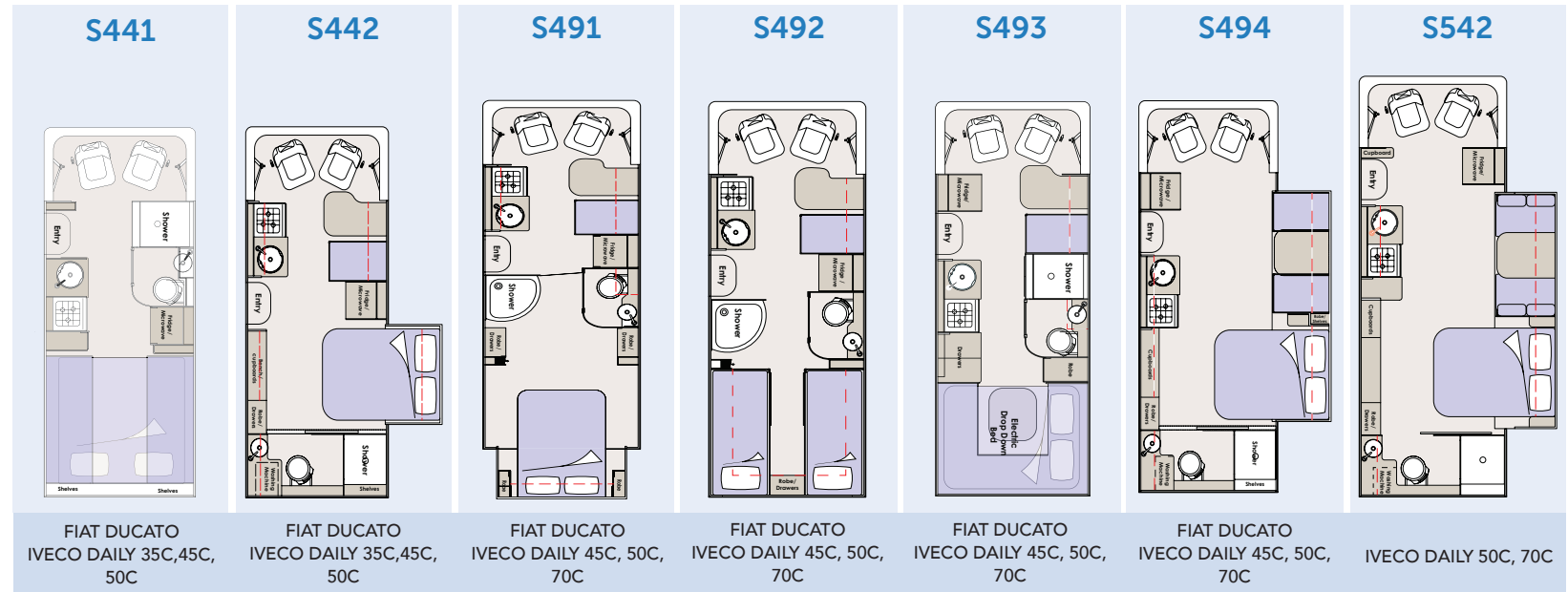

KEY INFORMATION	S441 S442		S491 S492 S493 S494		S542		S601	
	LENGTH	7.1m	7.5m	8.0m	8.6m			
WIDTH	2.5m	2.5m	2.5m	2.5m				
HEIGHT	3.2m	3.2m	3.2m	3.2m				
SLEEPS	2/4	2/4	2/4	4/6				
GVM (KG)	4495	4995 5200	5200	7200				
LICENSE	CAR	CAR/LR	LR	LR				
GARAGE	YES	YES*	YES	NO				
UTILITY BAR	YES	YES*	YES	YES				

\*NA S491



1. S494 incorporates a large dinette and amazing storage options above and at the end of the bed. 2. S441 large rear lounge with **insulated panoramic windows**, incorporates drawers underneath adding the amazing storage in this compact unit. At night the oversize **queen north/south electric drop down bed** allows you access the bed without climbing over your partner. 3. Forward facing seating allows for **child restraints** (layout specific) 4. Rear bathroom configuration has ample storage including drawers, overhead cabinets, and shelves. Every Switch has the provision for an optional washing machine.

## HOME SPECIFICATIONS

	S441	S442	S491	S492	S493	S494	S542	S601
<b>CABIN / CHASSIS</b>								
Blockout Window Thermal Blind Set	•	•	•	•	•	•	•	•
Reverse Camera	•	•	•	•	•	•	•	•
<b>Swivel Driver &amp; Passenger Seat</b>	•	•	•	•	•	•	•	•
<b>CLIMATE CONTROL</b>								
<b>Air Conditioner 2400W</b>	•	•	•	•	•	•	•	•
Roof FAN Bathroom Hatch	•	•	2	2	2	•	•	2
Roof Hatch Finch Vision Vent	•	•	•	•	•	•	•	•
<b>ELECTRICAL LIGHTING</b>								
Boot Light With Switch	•	•	•	•	•	•	•	•
LED Strip In Step Well	•	•	•	•	•	•	•	•
Reading Lights	•	•	•	•	•	•	•	•
Under Awning Strip Light	•	•	•	•	•	•	•	•
<b>ELECTRICAL POWER SYSTEMS</b>								
12V BMS Control System Projecta	•	•	•	•	•	•	•	•
Battery 110 AGM	•	•	•	•	•	•	•	•
Double USB + 12v Socket	•	•	•	•	•	•	•	•
<b>Solar Panel 170w</b>	•	•	•	•	•	•	•	•
<b>ENTERTAINMENT</b>								
Speakers External Pair	•	•	•	•	•	•	•	•
Speakers Internal Pair	•	•	•	•	•	•	•	•
Stereo Fusion MS-RA55	•	•	•	•	•	•	•	•
TV Antenna External	•	•	•	•	•	•	•	•
TV Combo 24" Internal	•	•	•	•	•	•	•	•
<b>EXTERNAL</b>								
<b>Entry Step Electric</b>	•	•	•	•	•	•	•	•
External Table	•	•	•	•	•	•	•	•
Mud Flap Sunliner	•	•	•	•	•	•	•	•
<b>EXTERNAL AWNINGS MAIN</b>								
Rollout	•	•	•	•	•	•	•	•
<b>HANDLES</b>								
External Entry Illuminated	•	•	•	•	•	•	•	•
Positive Catch Handles	•	•	•	•	•	•	•	•
<b>KITCHEN</b>								
3 Gas 1 Electric Burner + Mini Grill Combo	•	•	•	•	•	•	•	•
<b>Bench Extension</b>	•	•	•	•	•	•	•	•
Microwave	•	•	•	•	•	•	•	•
Rangehood	•	•	•	•	•	•	•	•
Sink Round With Lid	•	•	•	•	•	•	•	•
Splashback With Pockets	•	•	•	•	•	•	•	•
3 Way 175L	•	•	•	•	•	•	•	•
<b>MATRESS</b>								
Double 4'6" x 6'2" x 6'	-	•	•	-	-	•	-	-
King 6' x 6' 2" x 6'	-	-	-	-	-	-	-	•
Queen 5' x 6' 2" x 6'	-	-	-	-	•	-	-	-
Single 2'6" x 6' 2" x 8'	-	-	-	2	-	-	-	-
<b>PLUMBING ITEMS</b>								
Vanity Basin Sink Ceramic	•	•	•	•	•	•	•	•
<b>External Shower</b>	•	•	•	•	•	•	•	•
External Water Filler	•	•	•	•	•	•	•	•
Gas Bottles 4kg	2	2	2	2	2	2	2	2
Hot Water Service Gas + Electric	•	•	•	•	•	•	•	•
Water Pump	•	•	•	•	•	•	•	•
<b>PLUMBING TANKS</b>								
Tank Fresh 100 Lt	•	•	•	•	•	•	•	•
Tank Waste 55 Lt	•	•	•	•	•	•	•	•

	S441	S442	S491	S492	S493	S494	S542	S601
<b>SAFETY</b>								
Fire Extinguisher	•	•	•	•	•	•	•	•
Internal Gas Detector Alarm	•	•	•	•	•	•	•	•
Internal Smoke Alarm	•	•	•	•	•	•	•	•
Internal Step Carpet Mat Sunliner	•	•	•	•	•	•	•	•
<b>OPTIONS</b>								
Oven	o	o	o	o	o	o	o	o
Additional Solar	o	o	o	o	o	o	o	o
Lithium Batteries	o	o	o	o	o	o	o	o
Diesel Heater	o	o	o	o	o	o	o	o
Inverter	o	o	o	o	o	o	o	o
Sleeper Peak with bunk net & ladder	o	o	o	o	o	o	o	o
Wall mount washing machine	o	-	o	o	-	-	-	o
Free Standing washing machine	-	o	-	-	-	o	o	o

## CHASSIS SPECIFICATIONS

	FIAT- DUCATO X295.H16.S7	FIAT- DUCATO X295.H17.S7	IVECO- DAILY 35 S13	IVECO- DAILY 45 C18A8	IVECO- DAILY 50 C18HA8	IVECO- DAILY 70 C21HA8/P
Engine	2.3 Ltr	2.3 Ltr	2.3 Ltr	3.0 Ltr	3.0 Ltr	3.0 Ltr
Power (hp/kw)	160 /117	177/130	126/93	176/130	180/132	210/155
Torque (Nm)	450	450	320	400	430	470
GVM (kg)	4400	4400	3800	4495	4495/5200	7200
Transmission	9 Speed Auto	9 Speed Auto	8 Speed Auto	8 Speed Auto	8 Speed Auto	8 Speed Auto
Driven Wheels	Front	Front	Rear	Rear	Rear	Rear
Tyre Size	225/75 R 16	225/75 R 16	195/75 R16	195/75 R16	195/75 R16	225/75 R16
Ani-Lock Brakes (ABS)	STD	STD	STD	STD	STD	STD
Traction Control	STD	STD	STD	STD	STD	STD
Stability Control	STD	STD	STD	STD	STD	STD
Warranty Period (Yrs/Km's)	5 Yr/200,000	5 Yr/200,000	3 yr/200,000	3 yr/200,000	3 yr/200,000	3 yr/200,000
Wheel Base	4035	4035	4100	4350	4750	5100
ECAS	-	-	-	-	-	STD
Suspension Seats	-	-	-	-	STD	STD

To explore more take a photo of the below QR codes



MORE  
SWITCH



IMAGES &  
360 TOURS



ABOUT US



DEALERS



IN STOCK



GARAGE

# SWITCH

THE BEST PLACE TO START

Due to continuous improvements and availabilities, specifications, inclusions & brands are subject to change without notice. All capacities, weights, lengths and measurements are approximates. Images used may not depict the actual model or may contain items that are not standard or available.

This document should be used as a guide only.  
For more detailed information please contact your local dealer.

[www.sunliner.com.au](http://www.sunliner.com.au)

